

See Page 2

Closure details:  
 Lowgate Street closed from a point 50m south of junction with Castel Street/lowgate Street closed for a further 50m south.

Temporary Walkway required within the closure.

SP1 x2

**B1077 CLOSED At Castle Street For Access To Debenham/Occold Follow Diversion**

SP2 x6

**B1077 CLOSED At Orchard Close For Access To Eye/Diss Follow Diversion**

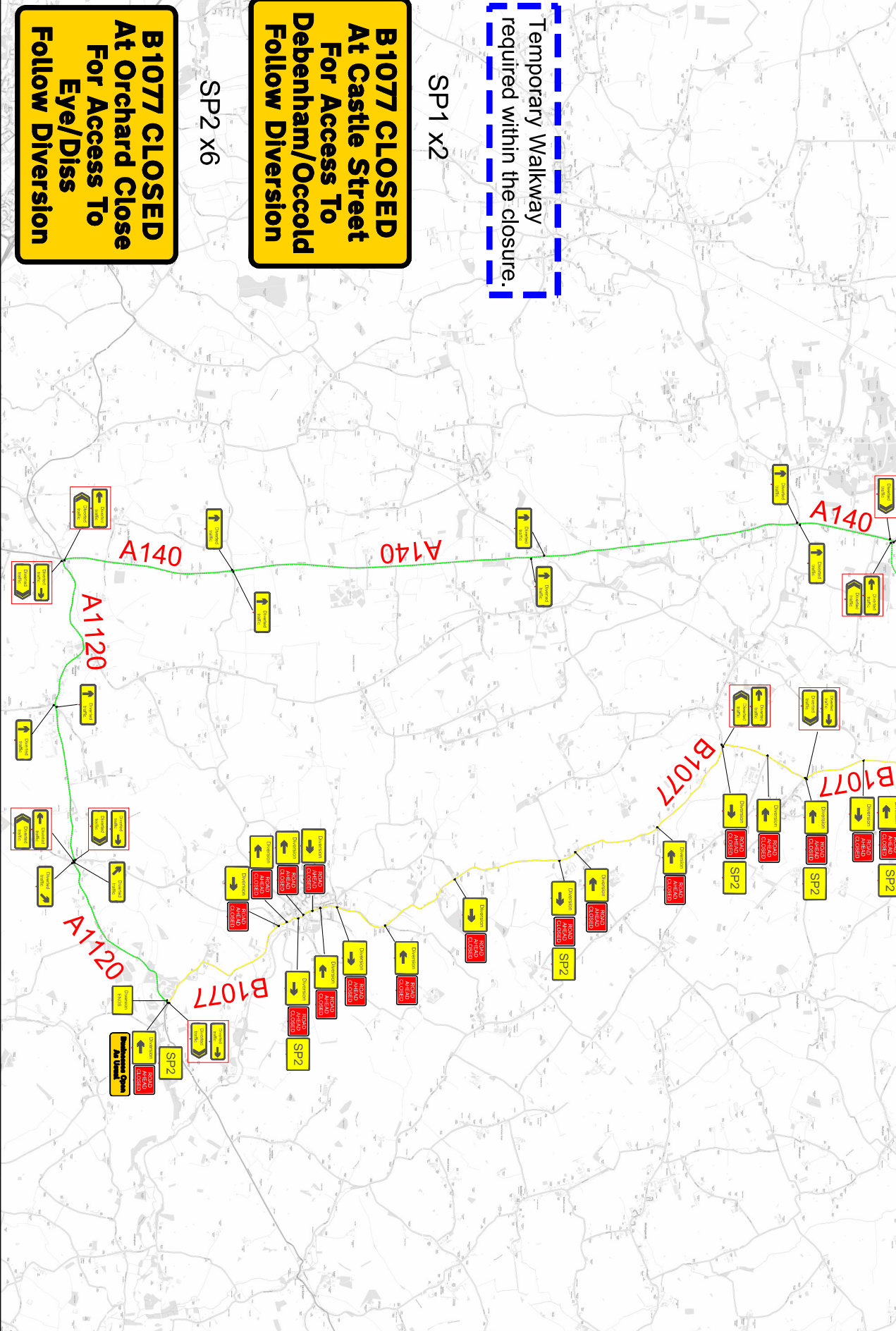

TMO-PL-008rev4 | Review Date - 07/04/19

**TMO Highways**

Unit 19c Diss Business Park  
 Diss Norfolk IP22 4GT  
 Tel:01379 676462

**Customer Details:**

**GARROD CONSTRUCTION**  
 CIVIL ENGINEERING

Customer Ref:  
 Agent: Leigh Garrod

**Drawing Details:**  
 TM Type: Road closure  
 Location: Matchbook Cottage,  
 24A Lowgate Street, Eye,  
 IP23 7AS

**Planner:** Andy Rayner  
 Email: andy.rayner@tmohighways.co.uk

- Key**
- Sign Diagram
  - Advances Location
  - Road Closure Location
  - Access Only
  - Diversion Route
  - Sign To Be On A Frame

**Drawn/Revised**

Drawn by	Revised by	Revision number	Date
A.R	-	00	22/09/16

- Main Diversion Route:**  
 B1117 Yaxley Road,  
 A140,  
 A1120 Stowmarket Road,  
 A1120 The Street,  
 A1120 Pettaugh Road,  
 A1120 Stonham Aspall Road,  
 A1120 Church Road,  
 A1120 Framsden Road,  
 A1120 Boundary Corner,  
 And Vice Versa.

**Drawing checked by:**

**PLEASE NOTE:**  
 a. All Traffic Management to comply with current chapter 8 and Safety at Street Works and Roadworks (A code of practice),  
 to all road markings and signage to conform to the Traffic Signs Regulations and General Directions 2002.

This Drawing has been produced for the specific client and should not be defined in drawing and customer details and is not intended for any other purposes.